

N12-K2 Hadron FWD-lean Set
(= Lean-block + Lever + hardware)

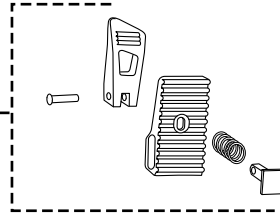

N2-F2 Asym Hadron Hiback Set
(= Hiback + EVA-pad + FWD-lean assembled)

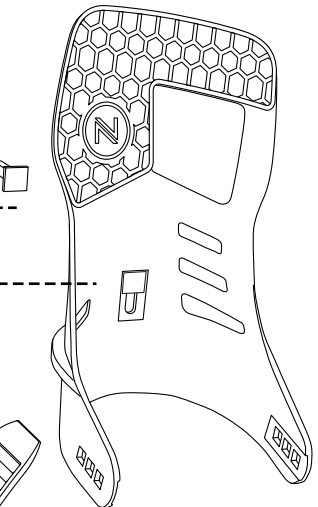

Axion Ankle-ratchet w/ screw **N41-K1**

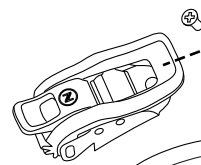

Ankle ComfortFit-strap w/ QS-latch **N11-A1**

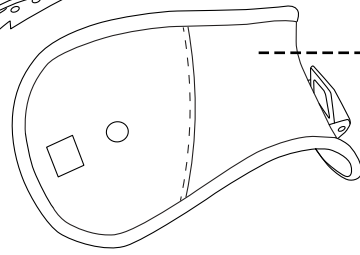

18-F1 LSR Pivot Ankle-ladder

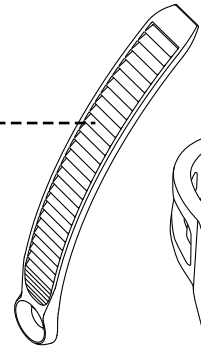

QuickSet Ankle-ladder **17-G1**

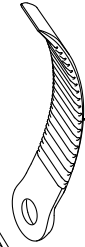

N28-F1 Axis.N1 C-bolt Set
(= Screw M5*22 + Pivot-Washer + T-nut)

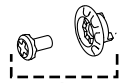

Axion Toe-ratchet w/ screw **N41-L1**

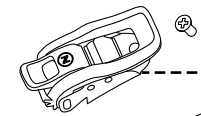

Hexo Toecap w/ QS-latch **11-A1**

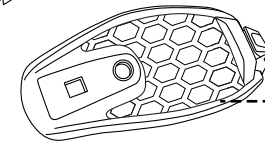

N1-F1 Axis.N1-Series Muon Baseplate+Heelcup

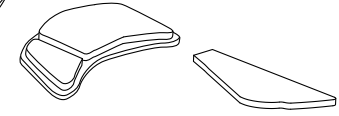

QuickSet Toe-ladder w/ plug **N17-D1**

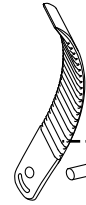

18-A1 LSR Toe-ladder w/ plug

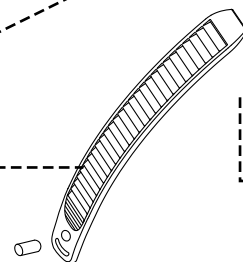

Axis-NXS Baseplate-Cushioning set
(= Heel-EVA + Rocker-EVA) **08-C1**

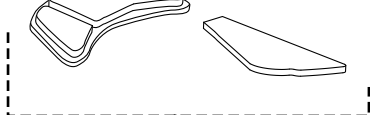

21-H2 Multi-Disk Mounting disk w/ screws (M6*14.5)

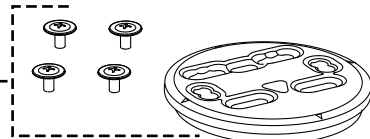

Mounting screws (M6*14.5) **42-G1**

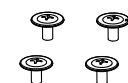

N12-K2 Hadron FWD-lean Set
(= Lean-block + Lever + hardware)

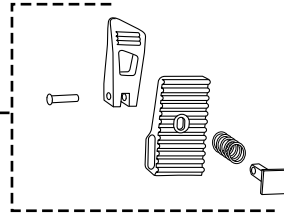

N2-F2 Asym Hadron Hiback Set
(= Hiback + EVA-pad + FWD-lean assembled)

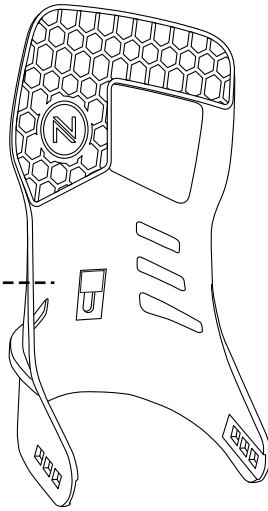

N11-B1 Ankle ExoFrame Set
(= AnkleSpine + ExoFrame strap + QuickSet latch)

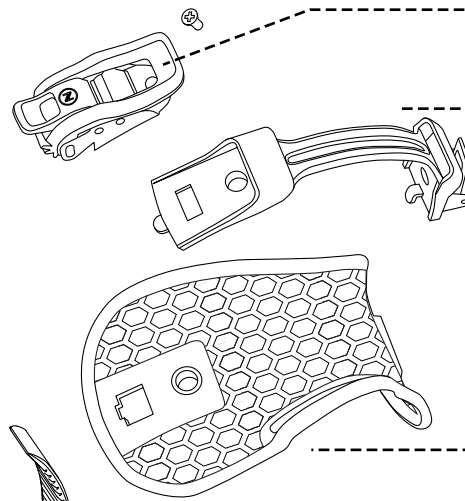

18-F1 LSR Pivot Ankle-ladder

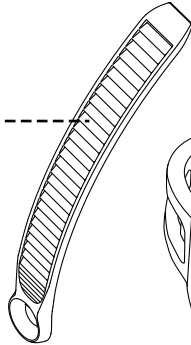

17-G1 QuickSet Ankle-ladder

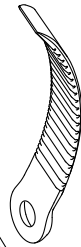

N28-F1 Axis.N1 C-bolt Set
(= Screw M5*22 + Pivot-Washer + T-nut)

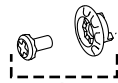

N41-L1 Axion Toe-ratchet w/ screw



N1-G1 Axis.N1-Series Kaon Baseplate+Heelcup

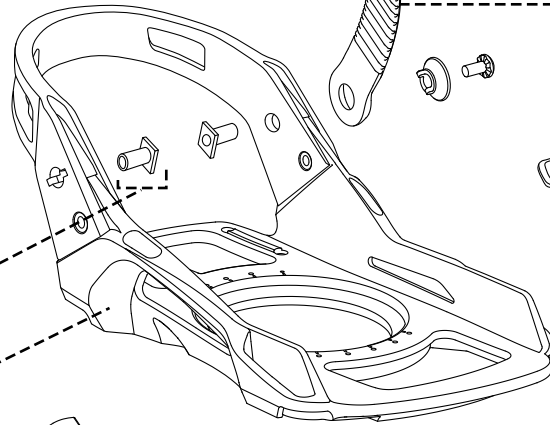

11-A1 Hexo Toecap w/ QS-latch

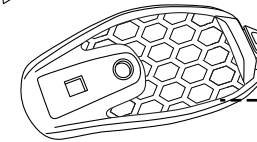

18-A1 LSR Toe-ladder w/ plug

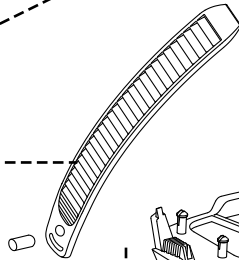

N17-D1 QuickSet Toe-ladder w/ plug

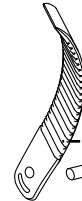

18-A1 Axis.N1 Kaon Baseplate-Cushioning set
(= Bankbed + Heel-basepad + Rocker-EVA)

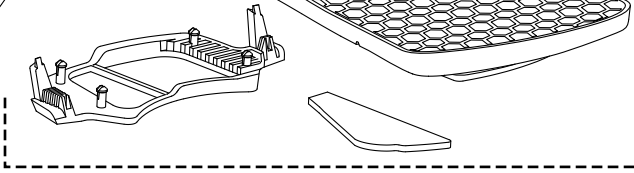

21-H2 Multi-Disk Mounting disk w/ screws (M6*14.5)

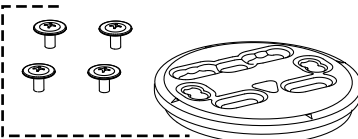

42-G1 Mounting screws (M6*14.5)

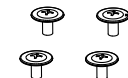

N12-K2 Hadron FWD-lean Set
(= Lean-block + Lever + hardware)

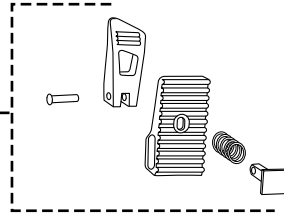

N2-F2 Asym Hadron Hiback Set
(= Hiback + EVA-pad + FWD-lean assembled)

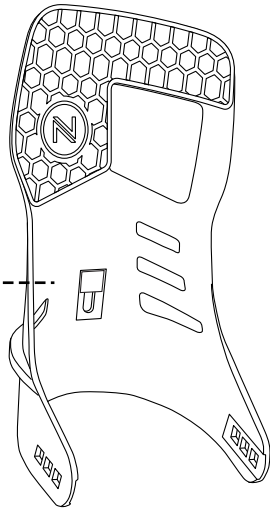

Axion Ankle-ratchet w/ screw **N41-K1**

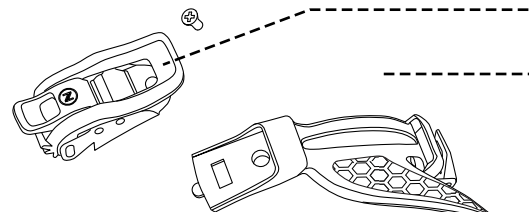

Hybrid ExoKush Set **11-K1**
(= ExoKush AnkleStrap + Hybrid Ankle-Spine + Insert-pods 11-L1 + QS-latches)

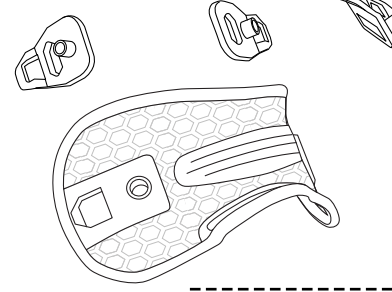

18-F1 LSR Pivot Ankle-ladder

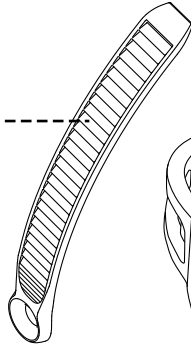

QuickSet Ankle-ladder **17-G1**

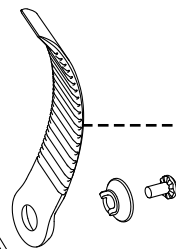

N28-F1 Axis.N1 C-bolt Set
(= Screw M5*22 + Pivot-Washer + T-nut)

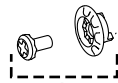

Axion Toe-ratchet w/ screw **N41-L1**



Hexo Toecap w/ QS-latch **11-A1**

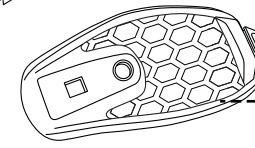

N1-G1 Axis.N1-Series Kaon Baseplate+Heelcup

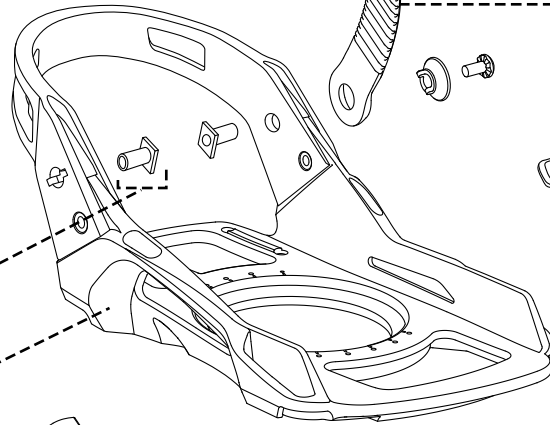

17-H2



18-A1 LSR Toe-ladder w/ plug

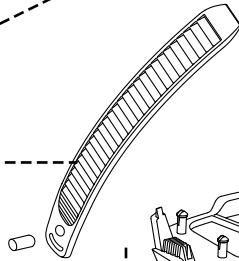

Axis.N1 Kaon Baseplate-Cushioning set **N8-A1**
(= Bankbed + Heel-basepad + Rocker-EVA)

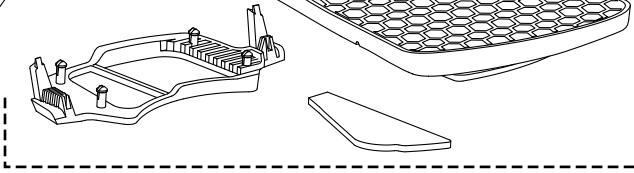

21-H2 Multi-Disk Mounting disk w/ screws (M6*14.5)

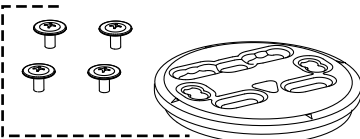

Mounting screws (M6*14.5) **42-G1**

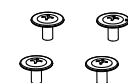

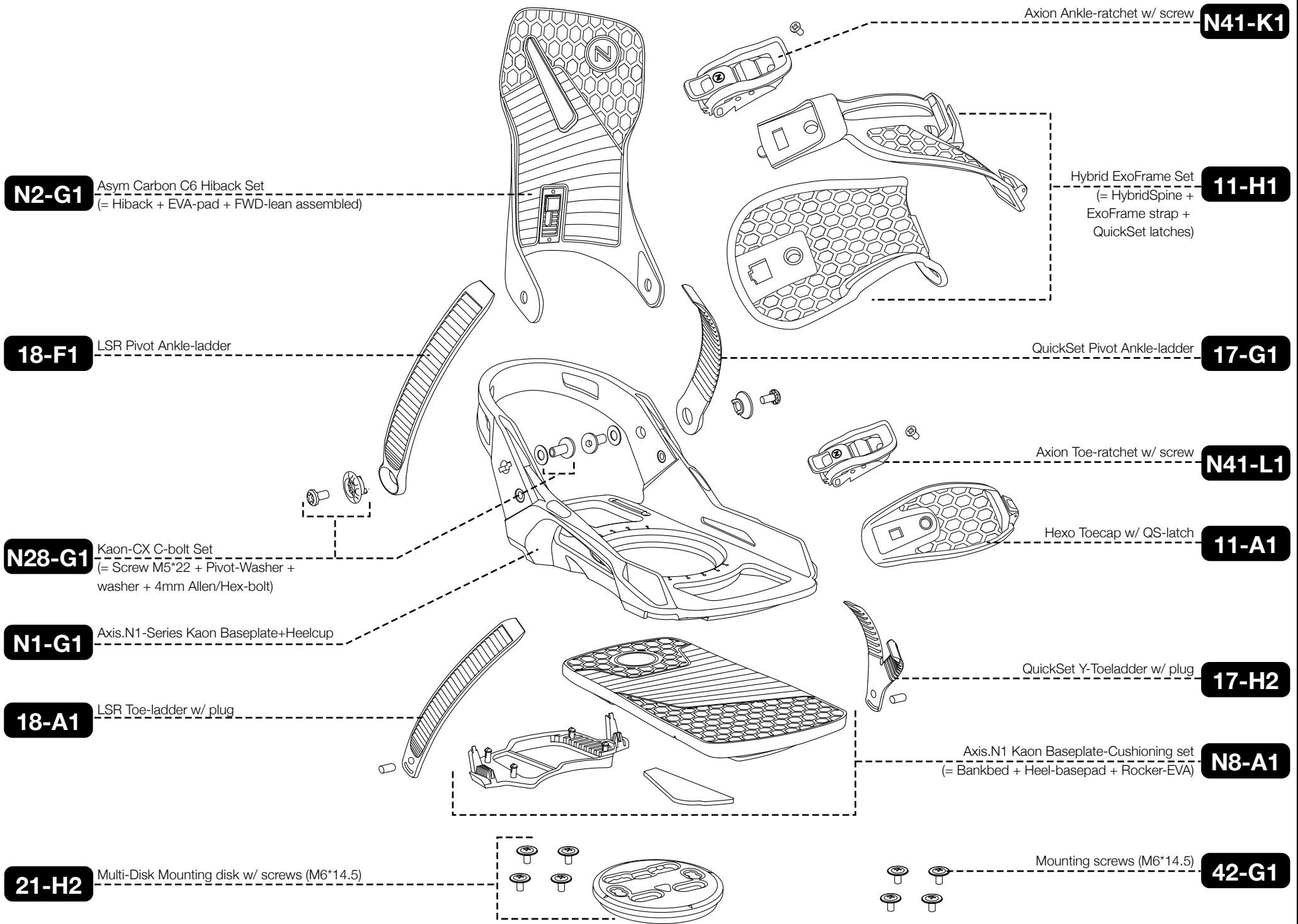

N12-K2 Hadron FWD-lean Set
(= Lean-block + Lever + hardware)

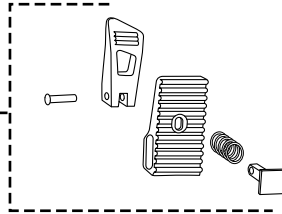

N2-F2 Asym Hadron Hiback Set
(= Hiback + EVA-pad + FWD-lean assembled)

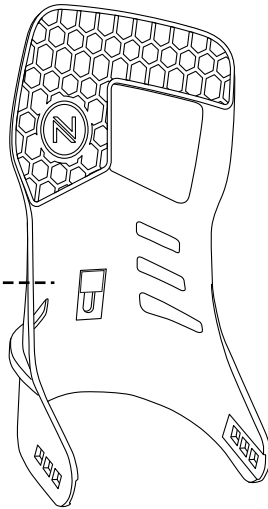

Axion Ankle-ratchet w/ screw **N41-K1**

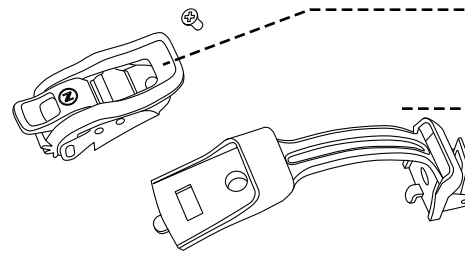

Ankle ExoFrame Set
(= AnkleSpine + ExoFrame strap + QuickSet latch) **N11-B1**

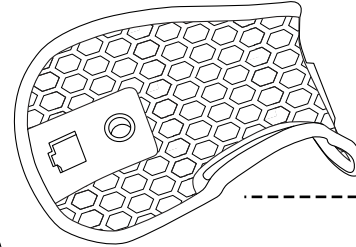

18-F1 LSR Pivot Ankle-ladder

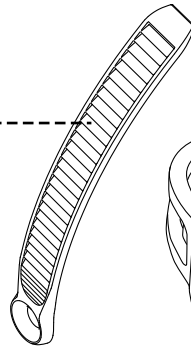

QuickSet Ankle-ladder **17-G1**

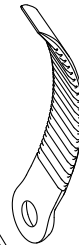

N28-F1 Axis.N1 C-bolt Set
(= Screw M5*22 + Pivot-Washer + T-nut)

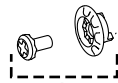

Axion Toe-ratchet w/ screw **N41-L1**

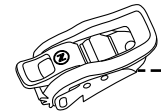

N1-F1 Axis.N1-Series Muon Baseplate+Heelcup

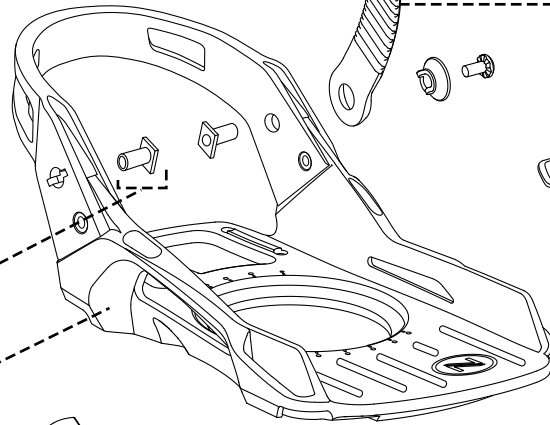

Hexo Toecap w/ QS-latch **11-A1**

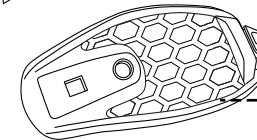

18-A1 LSR Toe-ladder w/ plug

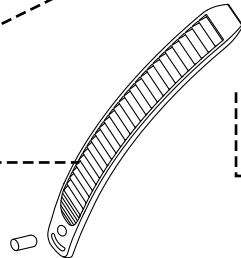

QuickSet Toe-ladder w/ plug **N17-D1**

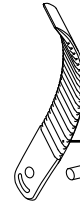

Axis-NXS Baseplate-Cushioning set
(= Heel-EVA + Rocker-EVA) **08-C1**

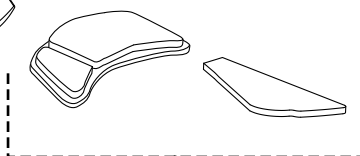

21-H2 Multi-Disk Mounting disk w/ screws (M6*14.5)

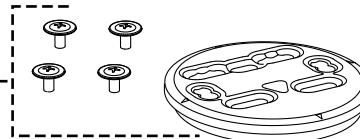

Mounting screws (M6*14.5) **42-G1**

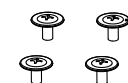

N02-H1 Magic Hiback

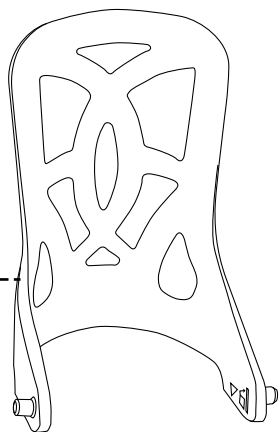

N18-M1 Magic Ankle-ladder

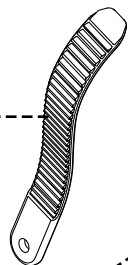

N19-A1 Magic Ankle-ladder Pods



N01-H1 Magic Baseplate Set
(= w/ EVA-pad +
Magic Mounting-hardware Set N42-E1)

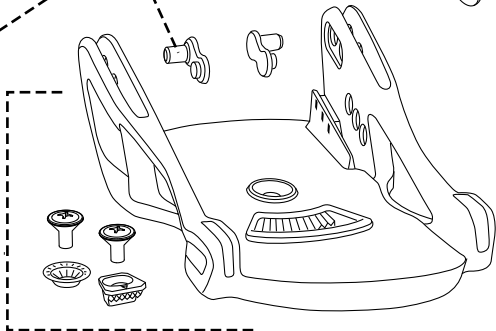

N18-N1 Magic Toe-ladder w/ plug

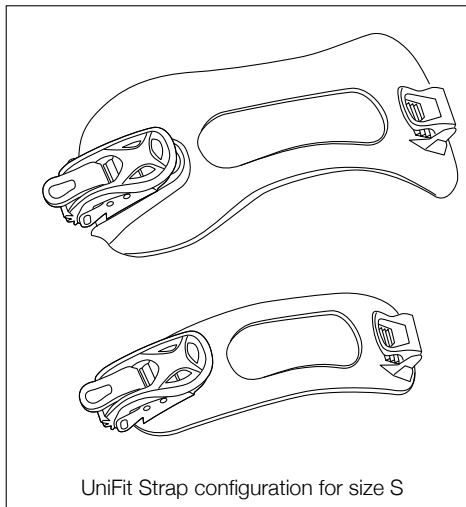
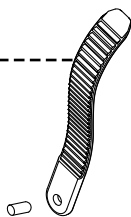

UniFit Strap-Set
w/ Atom-Ratchets **N11-E1**

UniFit Strap configuration for size S

Magic Ankle-connector **N17-K1**

Magic Toe-connector w/ plug **N17-L1**

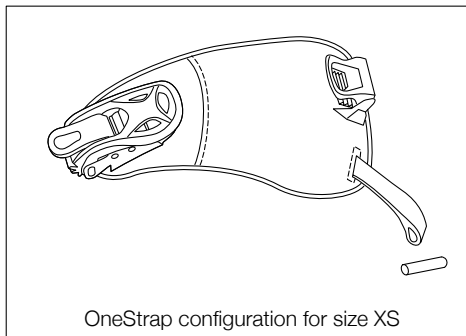

OneStrap set
w/ Atom-Ratchet + pin **N11-D1**

OneStrap configuration for size XS

